

PINNACLE ENGINEERING GROUP
INCORPORATED
1000 W. ILLINOIS ROUTE 173, SUITE 100
ANTIOCH, ILLINOIS 60010
TEL: 815.461.1111
WWW.PINNACLE-ENG.COM

SKIPPERBUD'S
24901 W. ILLINOIS ROUTE 173
ANTIOCH, ILLINOIS

CONCEPT DEVELOPMENT
PLAN A

SHEET
C-1
OF
C-2

WWW.PINNACLE-ENG.COM

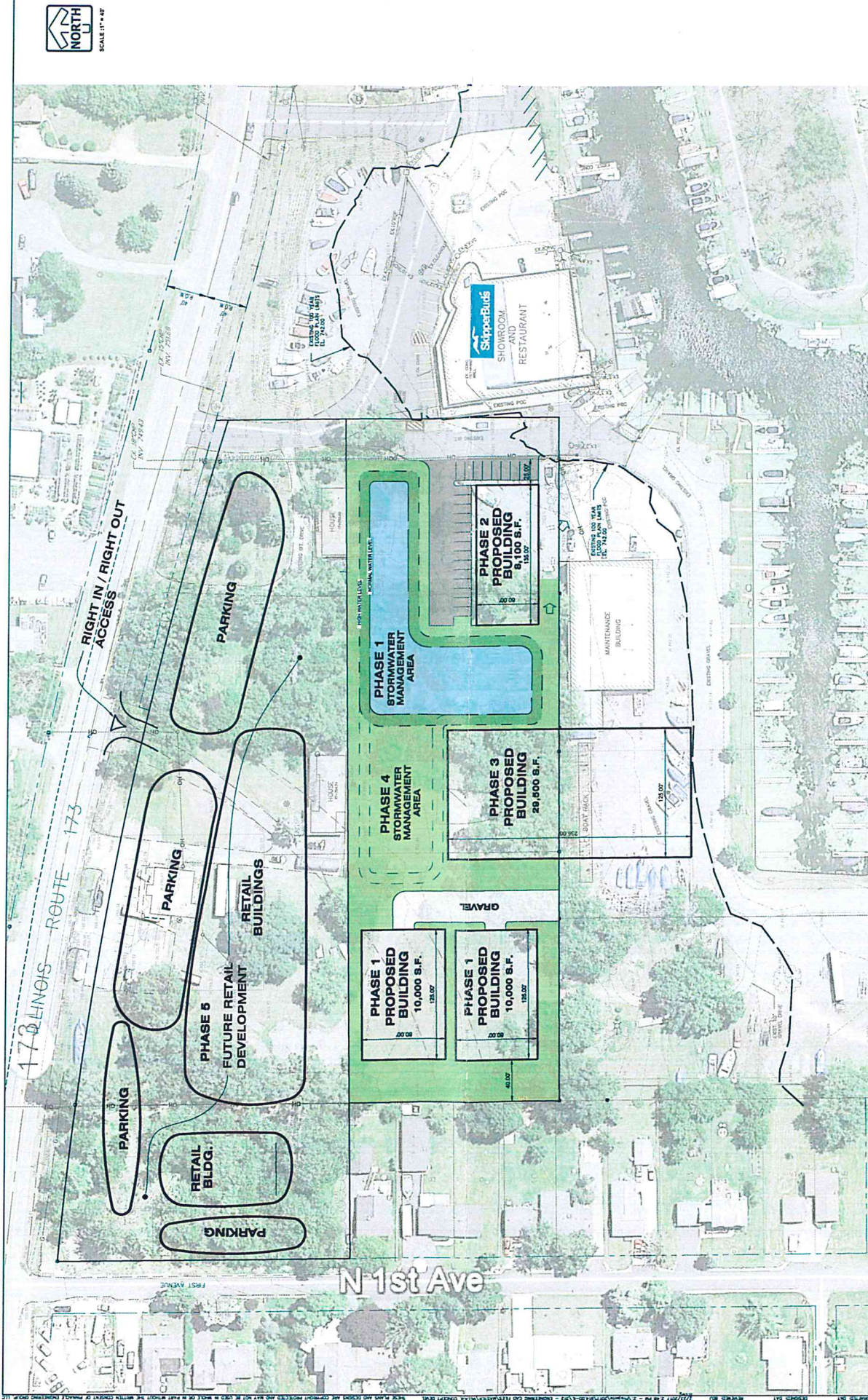

PINNACLE ENGINEERING GROUP
 1000 W. ILLINOIS ROUTE 173, SUITE 100, ANTIPOCH, ILLINOIS 60010
 TEL: 815.461.1111 FAX: 815.461.1112
 WWW.PINNACLE-ENGR.COM

SKIPPERBUD'S
24901 W. ILLINOIS ROUTE 173
ANTIPOCH, ILLINOIS

CONCEPT DEVELOPMENT
PLAN B

SHEET
C-2
 OF
C-2

REVISIONS

NO.	DESCRIPTION

PLAN / DESIGN / DELIVER

PROFESSIONAL ENGINEER
 REG. NO. 001234567
 STATE OF ILLINOIS

PROJECT NO. 173-001
 DATE: 08/15/2023

DESIGNED: DAT
 DRAWN: DAT
 CHECKED: DAT
 REVISIONS: DAT
 2/24/2017 10:13 AM - Z:\Projects\2017\014-00-ILL-312 - ENGINEERING CAD FILES\MASHKAVILAGE CONCEPT LEVEL
 THESE PLANS AND DESIGNS ARE COPYRIGHT PROTECTED AND MAY NOT BE USED IN WHOLE OR IN PART WITHOUT THE WRITTEN CONSENT OF PINNACLE ENGINEERING GROUP, LLC

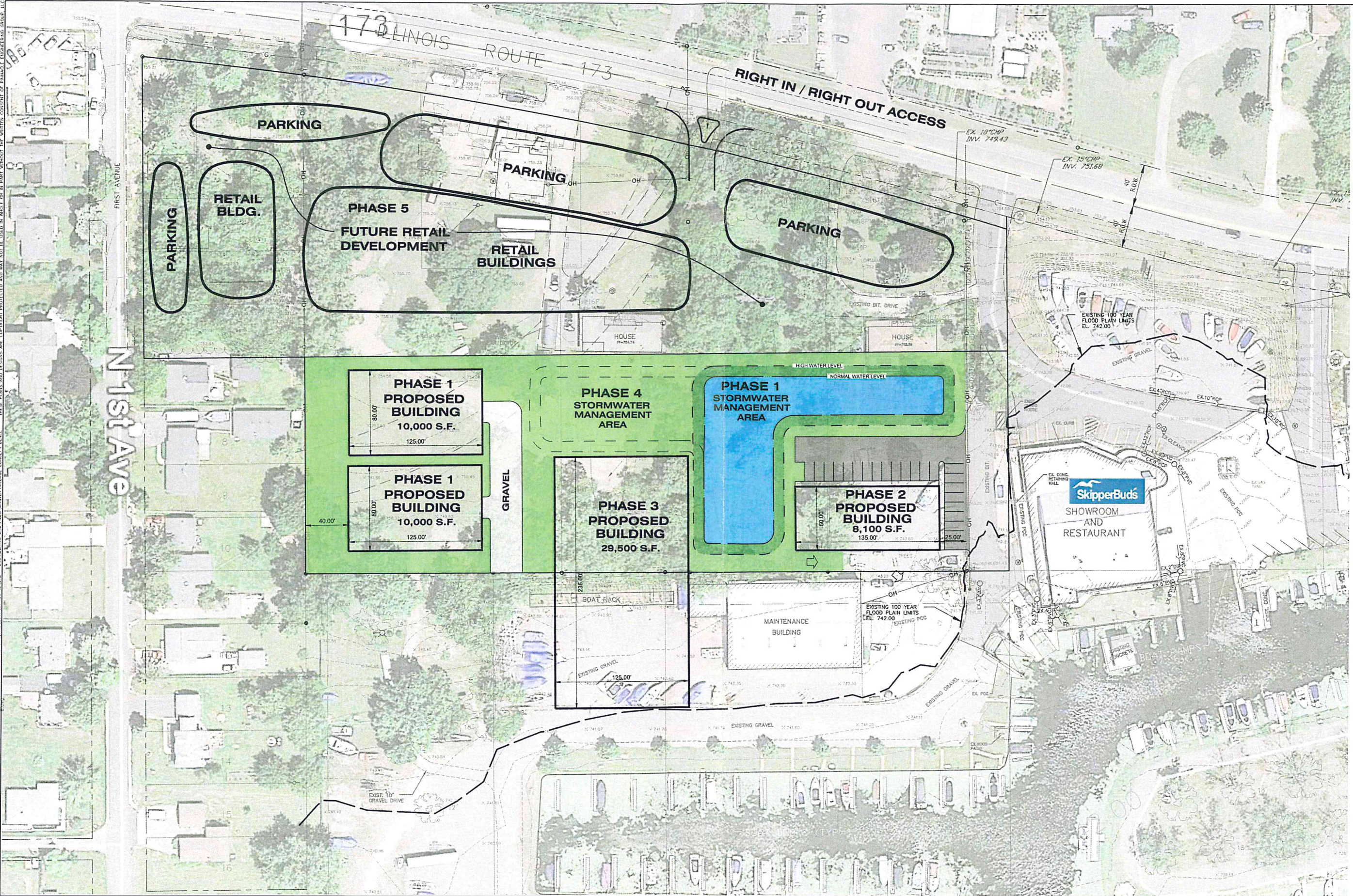

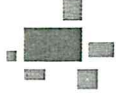
PINNACLE ENGINEERING GROUP
 ENGINEERING | NATURAL RESOURCES | SURVEYING
 PLAN | DESIGN | DELIVER
www.pinnacle-engr.com
 CHICAGO OFFICE:
 1051 E. MAIN ST. | SUITE 217
 EAST BUNDEE, IL 60118
 (847) 551-5300
 CHICAGO | MILWAUKEE | NATIONWIDE

SKIPPERBUD'S
24901 W. ILLINOIS ROUTE 173
 ANTIOCH, ILLINOIS

REVISIONS	

CONCEPT DEVELOPMENT
PLAN B

SHEET
C-2
 of
C-2
 PEG JOB No. 215-00-ILL
 PEG PK. DAT
 START DATE 02/22/17
 SCALE 1" = 40'
 © COPYRIGHT 2018





SkipperBud's Yacht Center